

OKLAHOMA DEPARTMENT OF TRANSPORTATION					
FED. ROAD DIST. NO.	STATE	PROJ. NO.	FISCAL YEAR	SHEET NO.	TOTAL SHEETS
	OKLA.				
DESCRIPTION		REVISIONS		DATE	

STATE OF OKLAHOMA
DEPARTMENT OF TRANSPORTATION

SURVEY OF
U.S. 62
SWO 4889(1)
J/P NO. 27956(04)

OKLAHOMA

SURVEY OF U.S. 62, INTERSECTION MODIFICATION AT S.H. 10 EAST OF MUSKOGEE,
MUSKOGEE COUNTY, OKLAHOMA

INDEX OF SHEETS

- TITLE SHEET
- 2-3 SURVEY INFORMATION (notes, letters)
- COGO POINTS & BENCH MARK LIST
- HORIZONTAL ALIGNMENT DATA
- HORIZONTAL CONTROL DIAGRAM
- 7-8. GEOMETRIC DATA SHEETS
- 9-10. SURVEY DATA SHEETS

STATE OF OKLAHOMA
DEPARTMENT OF TRANSPORTATION
SURVEY DIVISION

SWO 4889(1) J/P 27956 (04) : Muskogee CO.

HORIZONTAL CONTROL:
 Oklahoma Coordinate System of 1927 Zone.
 Oklahoma Coordinate System of 1983(2002) NORTH Zone.
 Oklahoma Dept. of Transportation Plane Coordinate System of 1927 Zone.
 Oklahoma Dept. of Transportation Plane Coordinate System of 1983 Zone.
 Arbitrary Coordinate System

HORIZONTAL PLANE DATUM DEFINITION:
 Oklahoma Department of Transportation coordinates were derived by multiplying the Oklahoma Coordinate Systems of 1927 or 1983 by the combined adjustment factor of 1.00010. The ODOT Coordinate System is 2360 feet above sea level.

1. Primary adjusted to Oklahoma North Zone (B) Order
 Stations 7400, 7401
 A) Closure before adjustment X NA : Y NA Angles NA
 Trav. Length NA No. Angles NA : 1: NA
 B) : is (B) Order before adjustment.
 C) Method of Distance Measurement:
 Electronic GPS Triangulation Chained
 D) Instrument used for angles

2. Secondary adjusted to Primary Control (B) Order
 Stations 1-6, 300-304
 A) Closure before adjustment X NA : Y NA Angles NA
 B) NA : is (B) Order: Tied to
 C) Method of Distance Measurement:
 Electronic GPS Triangulation Chained
 D) Instrument used for angles Sokkia Set2B

VERTICAL CONTROL IS (3rd) order. Level Line taken from 7401 to 7400
 3rd order and tied to 1-6, 300-304 3rd order.
 NGVD 29 datum
 NAVD 88 datum

ACCURACY DEFINITION:
 (1) HORIZONTAL: (3rd Order = Class I = 1 : 10,000')
 (3rd Order = Class II = 1 : 5,000')
 (2) VERTICAL: (1st Order = 0.017 Ft. x sqrt. of Mi.) (2nd Order = 0.035 Ft. x sqrt. of Mi.)
 (3rd Order = 0.050 Ft. x sqrt. of Mi.)

Distribution:
 Copy w/survey reports
 Copy in each Alignment
 and level book

Robert Levine Johnston Jr.
 Professional Land Surveyor

8/1/2012
 Date

(FORM SD #20)
 Rev. 11/03

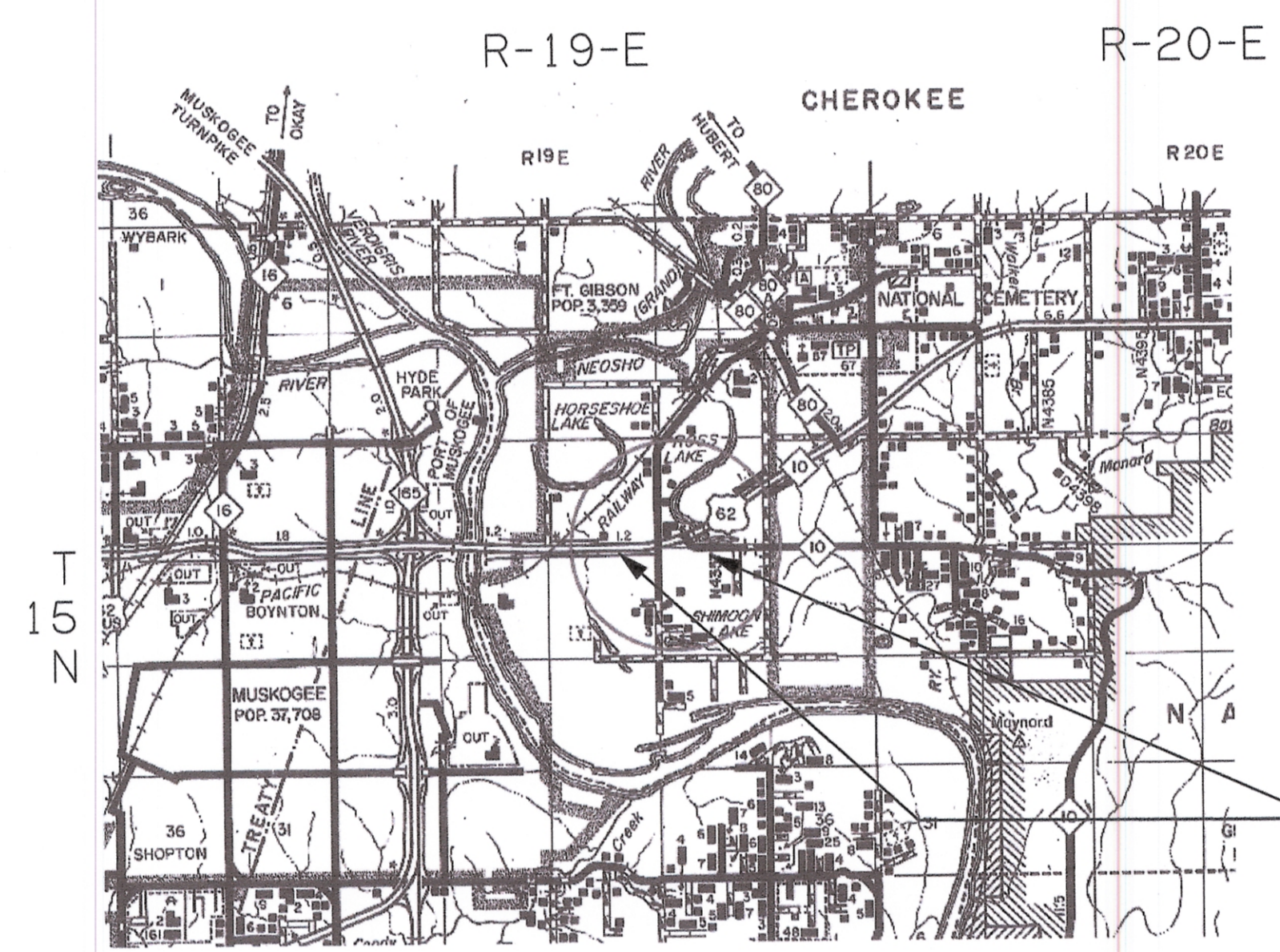

PROJECT EXTENTS

PROJECT LENGTH 3,000 Ft. 0.57 MI.

BEGINNING STATION FOR U.S. 62 : 400+00.00
 ENDING STATION FOR U.S. 62 : 430+00.00
 STATION 400+00.00 ON THIS SURVEY =
 STATION 400+00.00 ON SW02820(1) SURVEY AS SHOWN ON FAP NO. RF-404(43) PLANS

BEGINNING STATION FOR NS-435 GEORGETOWN CONNECTION : 100+00.00
 ENDING STATION FOR NS-435 GEORGETOWN CONNECTION : 114+15.04

BEGINNING STATION FOR S.H. 10 CONNECTION : 1000+00.00
 ENDING STATION FOR S.H. 10 CONNECTION : 1022+32.62
 STATION 1017+14.90 ON THIS SURVEY =
 STATION 15+49.97 S.H. 10 CONNECTION AS SHOWN ON FAP NO. RF-404(43) PLANS.

WATER - FORT GIBSON UTILITY AUTHORITY - 918-478-3712
 SEWER - FORT GIBSON UTILITY AUTHORITY - 918-478-3712
 CABLE ABOVE GROUND - ALLEGIANCE COMMUNICATIONS - 800-937-1397
 ELECTRIC - O.G. & E. - 405-840-5032
 GAS - OKLAHOMA NATURAL GAS - 918-684-4410
 COMMUNICATIONS - AT&T LONG LINES - 816-275-4014
 COMMUNICATIONS - AT&T (SW BELL) - 918-596-6804

THIS SURVEY MEETS THE OKLAHOMA MINIMUM STANDARDS FOR THE PRACTICE OF LAND SURVEYING AS ADOPTED BY THE OKLAHOMA STATE BOARD OF REGISTRATION FOR PROFESSIONAL ENGINEERS AND LAND SURVEYORS, MAY 17, 2010.

SPECIFICATIONS FOR SURVEYS FOR PRIMARY AND SECONDARY HIGHWAYS DATED MAY 1, 1999 GOVERN.
 SDS 1 OF 10

Electronic File Transfer Disclaimer:
 These Files, Drawings and/or Notes are provided for information only. The Oklahoma Department of Transportation (ODOT) and the Owner cannot be held responsible for the content or accuracy of these Files, Drawings and/or Notes due to conversions, software translations, or any other manipulation of said Files, Drawings and/or Notes. ODOT expressly disclaims any responsibility arising from any use of these Files, Drawings and/or Notes. To the full extent permitted by applicable law, the recipient of these Files, Drawings and/or Notes hereby agrees to defend, indemnify, and hold harmless ODOT and the Owner from and against any and all claims, suits, actions, damages, loss, liability or costs of every nature or description (including reasonable attorney's fees) arising from, or in any way attributable to or connected with any of these Files, Drawings and/or Notes.



OKLAHOMA DEPARTMENT OF TRANSPORTATION SURVEY DIVISION			
PLS	RLJ		
DRAWN	JAJ		
CHECKED	PED		
APPROVED	RLJ		
CREW	RJ, WW, LL, DN	SWO 4889 (1) PROJECT NO. 27956(04)	SHEET NO. _____

STATE OF OKLAHOMA
DEPARTMENT OF TRANSPORTATION

SWO 4889 (1) Job/Piece 27956 (4) Engr. Contract No. 1365-E

LAND SURVEYOR'S CERTIFICATION

I hereby certify that all land and property sub-division distances, angles, corners, and monumentation made or used in conjunction with this survey and depicted or recorded herein or hereon were recovered, established or re-established in substantial conformity with:

- Applicable instructions contained in the U.S. Government Bureau of Land Management publication "Manual of Survey Instruction",
- Its supplement, "Restoration of Lost or Obliterated Corners and Sub-division of Sections";
- "Oklahoma Minimum Standards for the Practice of Land Surveying" as adopted by the State Board of Licensure for Professional Engineers and Land Surveyors; and
- Sound land surveying practices;

including a thorough search, study, analysis and consideration of all existing records and field evidence.

I further certify that all survey monuments depicted exist and that all land survey work was done by me or under my direct supervision.

Dated this 01 day of August, 2012.

Robert Levine Johnston Jr. (Seal)
 Signature
 Robert Levine Johnston Jr.
 Printed Name

Oklahoma Licensed Land Surveyor No. 1792
 Certificate of Authorization No. 4193

